

ASSEMBLY PARTS SHEET

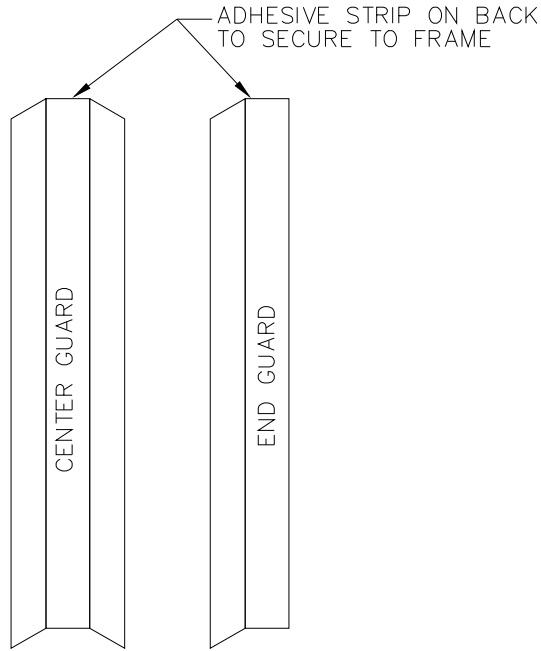

'GLARE GUARDS.' USE WITH 67" HIGH ANTHONY DISPLAY DOORS

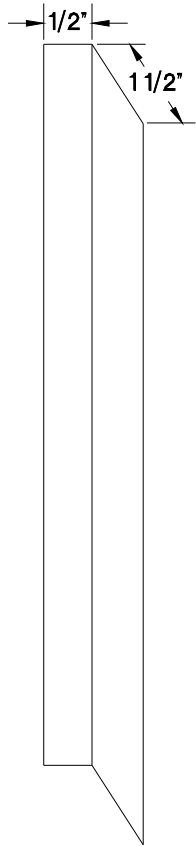
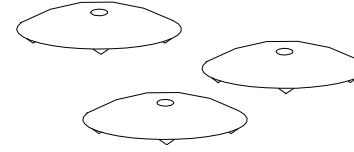

BLACK PLASTIC GROMMET. USE TO SECURE REVERSE TAB TO CEILING ON OUTDOOR MEMBRANE ROOFCAP

INTERIOR WINDOW TRIM. USE TO SECURE 2" THICK DISPLAY WINDOWS IN 4" THICK INSULATED WALL PANELS

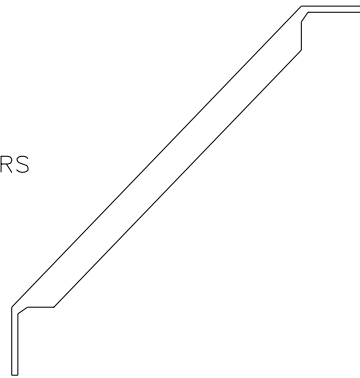

GALVANIZED HEADER BRACE PIPE USE TO SUPPORT HEADER BY ATTACHING TO HEADER FACE AND CEILING

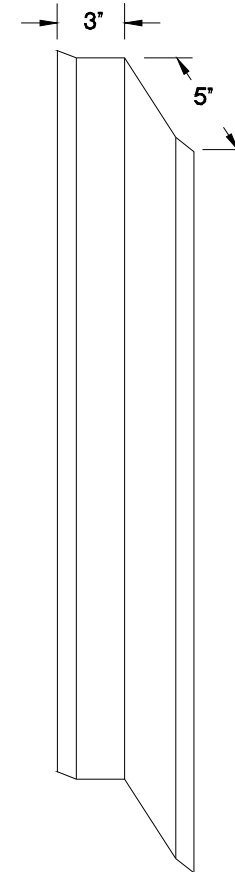

CORNER TRIM STRIP. USE TO ENCLOSE GAP BETWEEN WALL OF COOLER AND BUILDING WALL

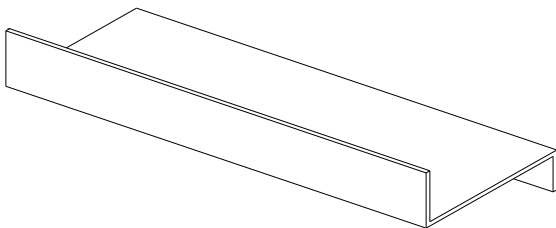

BLACK METAL LOWER RAIL GUARD. USE TO COVER RACEWAY AT BOTTOM OF ANTHONY DISPLAY DOORS

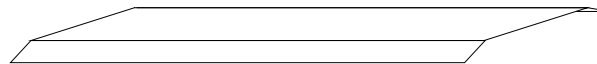

THRESHOLD PLATE. SECURE TO FLOOR AT DOOR OPENING TO COVER HEATER WIRE

6615 Nineteen Mile Road
Sterling Heights MI 48314-2117
PHONE: (800) 521-0398 FAX: (586) 254-0485

SRC REFRIGERATION
Refrigeration Specialists

Please note: Many SRC parts have been shown. Some may not apply to your particular job.